

Start – Setup SP2 & DP2

Thank you for your purchase of the Protectrix™ Automatic Garage Door Closing Timer. This manual supports **SP2, S+, DP2** and **(())** models.

Video - of how to install Protectrix is also available on our web site if you would prefer to watch what it takes. Go to www.protectrix.com then click on "how it works", a video link will appear at the top right hand side called "Installation Video for S+ and (())".

Step 1 – Learn Code

A) Find your "learn" button on the garage door opener, press the learn button for 1 second. The small light beside the learn button should go on.

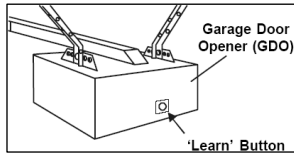

B) Next press the TEST SWITCH button on the front of Protectrix™. *You may need to press TEST SWITCH two to three additional times.* The garage light likely will turn off or blink and the small learn light on the garage door opener should flash or go off also. Protectrix will beep and blink. Protectrix is now programmed and can open and close your garage door.

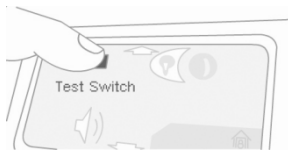

Test 1) Press the test button on the front of Protectrix, your garage door should open and close your garage door. Try 5 times, if this does not occur each time, either a) the remote has not been programmed correctly (repeat step 1), b) your opener is not supported, c) the remote lock switch is on (this may be next to the switch you use to open your garage door from inside your garage).

Step 2 – Install

a) Pick an area on the upper part of the Garage Door as shown in Diagram B to install Protectrix.

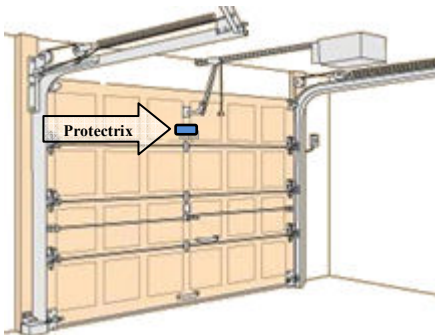
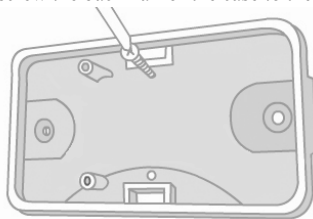

Diagram B: Installation location of Protectrix

b) Secure Protectrix to the garage door; screw the back half of the case to the garage door with two screws. If you do not want to use screws, you can use double-sided tape and apply it to the back of Protectrix then stick Protectrix to the garage door but ensure that the double-sided tape is securely attached to the garage door.



Caution! If Protectrix™ falls or releases from the garage door, Protectrix™ may inadvertently open the garage door, or never try to close the garage door. Ensure Protectrix is firmly attached!

Test 2) Set the Delay Time to tst (1 minute) and leave your garage door open. If the unit is not mounted to the garage door, the Protectrix unit must face down for the timer to start the countdown!

An alarm (blinking light and beeping sound) will start after 1 minute; the alarm will continue for 30 seconds, then the garage door should close. If the garage door does not close retry Test 1 again.

Warning! Test that Protectrix works on your garage door before depending on it, not testing it could mean your garage door will never close automatically.

Step 3 – Adjust Delay Time

On the front of Protectrix turn the knob¹ to the desired number of minutes that you would like Protectrix to wait² before trying to close the garage door.

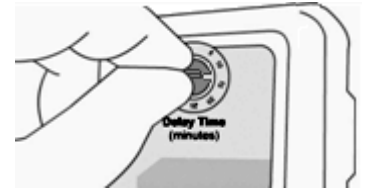

If you select 5m (3) that is 5 minutes, a setting of 1hr (7) would wait 1 hour before trying to close the door. You can turn the system off by selecting Off (0) for the delay time.

¹ The window on the dial points to the delay time.

² The maximum possible delay time is 4 hours.

Want Garage Door to Stay Open?

If you would like to leave your garage door open without Protectrix closing the door on you, you can disable it in one of two easy ways:

- Turn the delay switch on the front of Protectrix to off (0), although we recommend turning it to 4hr (9) just in case you forget to turn it back on again.
- Turn ON the Lock Switch on your garage door switch. It is usually mounted inside your garage on the wall. Protectrix will still set off an alarm after the set delay time and every delay time after that but it will not be able to close the door.

Alarms

- If the unit beeps once every few minutes the **Battery is Low**. If the unit beeps two or more times every few minutes the unit is defective and should be repaired or replaced.

- When the unit is mounted to the garage door and the door is closed, pressing the test switch should make the unit beep once. The unit should beep twice if the garage door is open. If the unit beeps one less beeps than it is supposed to the battery may be low.

Testing Regularly

Protectrix requires a 9-volt alkaline battery (included). Protectrix™ should be tested once a month. Leave the garage door open and wait for the set delay time for the timer to close the garage.

Technical Specifications

| | |
|--|---|
| Battery Type: | 9V/Alkaline |
| Battery Life: | approx: 1-4 years |
| The lifetime of the battery is determined upon many factors such as: how often the buzzer goes off, how many times Protectrix needs to close the garage door and the temperature. Under typical circumstances however the battery should last well over 2 years. | |
| Time until Door Automatically Closes: | 1min, 2min, 5min, 10min, 20min, 30min 1hr, 2hr, 4hr |
| Time Alarm Goes off Before Closing Door: | 30 seconds |
| Dimensions: | 5in x 2 ³ / ₄ in x 1 ¹ / ₄ in |

FCC Regulations:

Protectrix complies with Part 15 of the FCC Regulations. Its operation is subject to the following two conditions:

1. This device may not cause harmful interference.
2. This device must accept any interference that may cause undesired operation.

Warning!

- 1) *Never permit children, or those who behave like children, to be alone in the garage or to play with Protectrix.*
- 2) *Protectrix can close the garage door behind you locking you out of your house, be sure to have a way to get back into the house if the garage door is closed on you.*
- 3) *If Protectrix is removed from the garage door and the battery is still installed, the garage door may go up and down unexpectedly. Be sure to turn the Delay Switch to OFF to disable the unit.*
- 4) *When the battery is low, Protectrix may not be able to close the Garage Door, check monthly that Protectrix™ works. Protectrix will beep once every minute if the battery is low.*
- 5) *If the lock switch on your garage door is on, Protectrix will not be able to close your garage door.*
- 6) *Do not leave anything in the region where the garage door closes, Protectrix cannot detect any objects in the way of the garage door. Your garage door will stop and reverse, if your garage door does not have those features do not use Protectrix!*
- 7) *Pressing the button on the front of Protectrix has the same effect as pressing the button on your garage door remote; it can open your garage door, be careful not to press the button unexpectedly.*
- 8) *Protectrix cannot close the garage door if there is no power to the garage door opener or if something is blocking the garage door from closing!*
- 9) *If a car is running in the garage, Protectrix may close the garage door causing unsafe levels of Carbon Monoxide (poisonous/deadly) in Garage*